

# Freestanding Redevelopment

Avon Park, FL

FOR LEASE/BUILD TO SUIT



**851 US Highway 27 S, Avon Park, FL 33825**

## Property Highlights

- ◆ 3,669 SF former Bank of America building available for redevelopment on 1.41 Acre site
- ◆ Located in the heart of Avon Park, near Legoland Florida, Wal-Mart, Winn-Dixie, and McDonald's
- ◆ Abundant parking with **excellent visibility and access at a signalized intersection**
- ◆ Located on Highway 27, the region's main commercial corridor
- ◆ Average Daily Traffic: 29,000+

## Trade Area Demographics 2015

**Population:** 65,546

**Average Household Income:** \$45,541

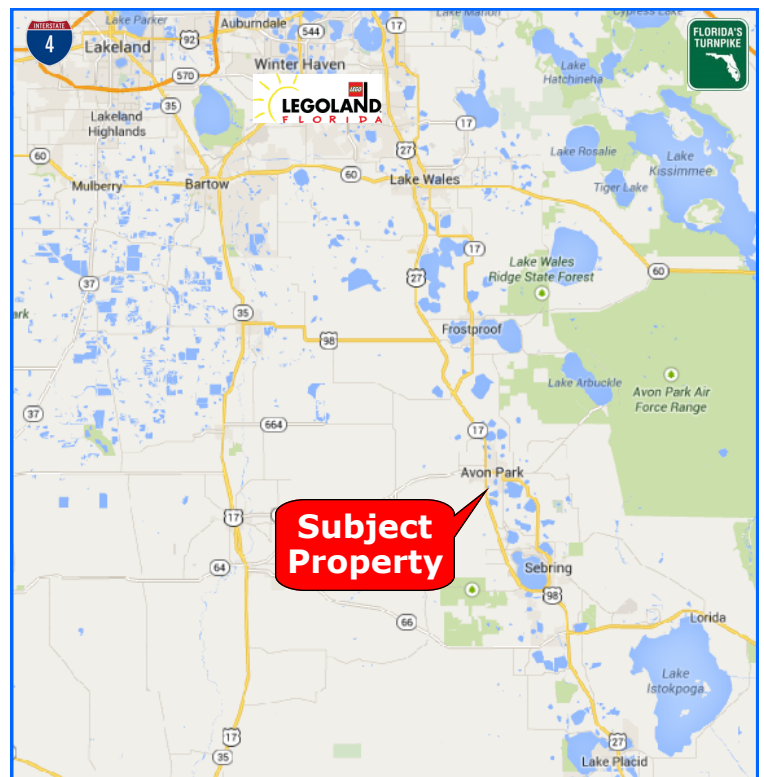

**Real Property Specialists**  
-62407-812-8000  
[www.realpropertyspecialists.com](http://www.realpropertyspecialists.com)

**REAL PROPERTY SPECIALISTS, INC**  
Appraisers • Brokers • Consultants

# Freestanding Redevelopment

## Avon Park, FL

**FOR LEASE/BUILD TO SUIT**

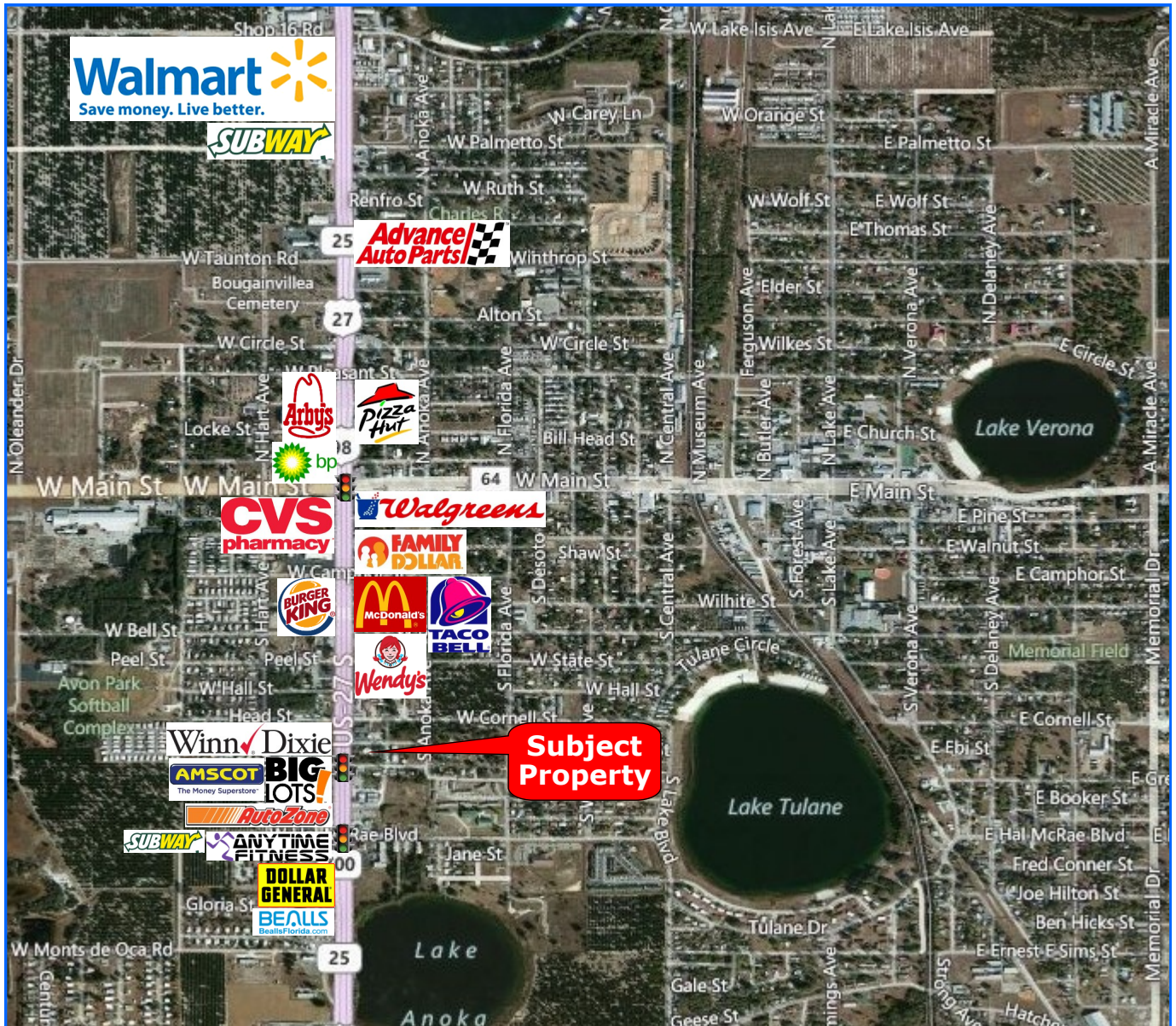

T: 407.812-8000 • F: 407.812.8885  
[www.RealPropertySpecialists.com](http://www.RealPropertySpecialists.com)

  
**REAL PROPERTY SPECIALISTS, INC**  
Appraisers • Brokers • Consultants

The information contained herein is submitted subject to errors, omissions, prior sale or lease, or withdrawal without notice.