

# Shoppes of Oviedo Marketplace

## Oviedo, Florida

**FOR LEASE**



### Red Bug Lake Rd at Oviedo Marketplace

#### Property Highlights

- Oviedo Marketplace is proximate to other major retail draws including the Oviedo Marketplace Mall which is anchored by Macys, Dillards and Sears.
- Other major retail draws in the area include Lowe's, Ross, Home Depot and Target.
- Oviedo and the surrounding northeast Orlando market are characterized by high household incomes and strong education. Seminole County has the highest median income in all of Florida and captures over one-third of the annual housing growth in Orlando.

#### Opportunities

- Anchor Space
- Mini-Anchor Space
- Specialty Shop Space
- End-Cap Space

#### Demographics 2005

	3 Miles	5 Miles
Population	54,268	154,533
Median Age	38	34.6
Avg. HH Income	\$89,886	\$72,730



2345 W Sand Lake Rd, Suite 100  
Orlando, FL 32809

9622 W Linebaugh Avenue  
Tampa, FL 33626

**REAL PROPERTY SPECIALISTS, INC**  
Appraisers • Brokers • Consultants

**T: 407.812-8000 • F: 407.812.8885**  
[www.RealPropertySpecialists.com](http://www.RealPropertySpecialists.com)

# Shoppes of Oviedo Marketplace

## Oviedo, Florida

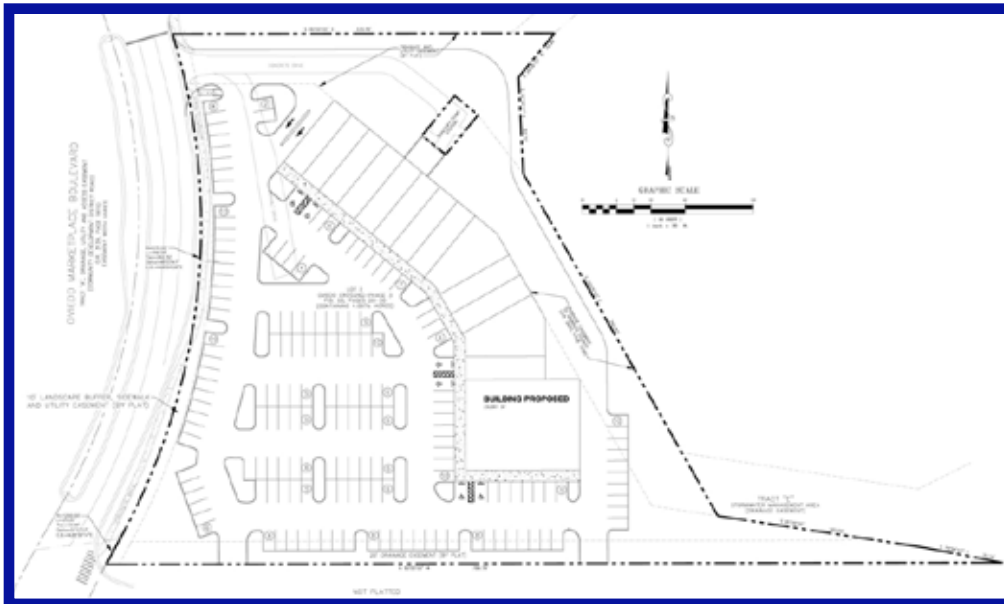

T: 407.812-8000 • F: 407.812.8885  
[www.RealPropertySpecialists.com](http://www.RealPropertySpecialists.com)

**REAL PROPERTY SPECIALISTS, INC**  
Appraisers • Brokers • Consultants

The information contained herein is submitted subject to errors, omissions, prior sale or lease, or withdrawal without notice.